

# ESCO Ultralok™ Tooth System

## Product Specifications

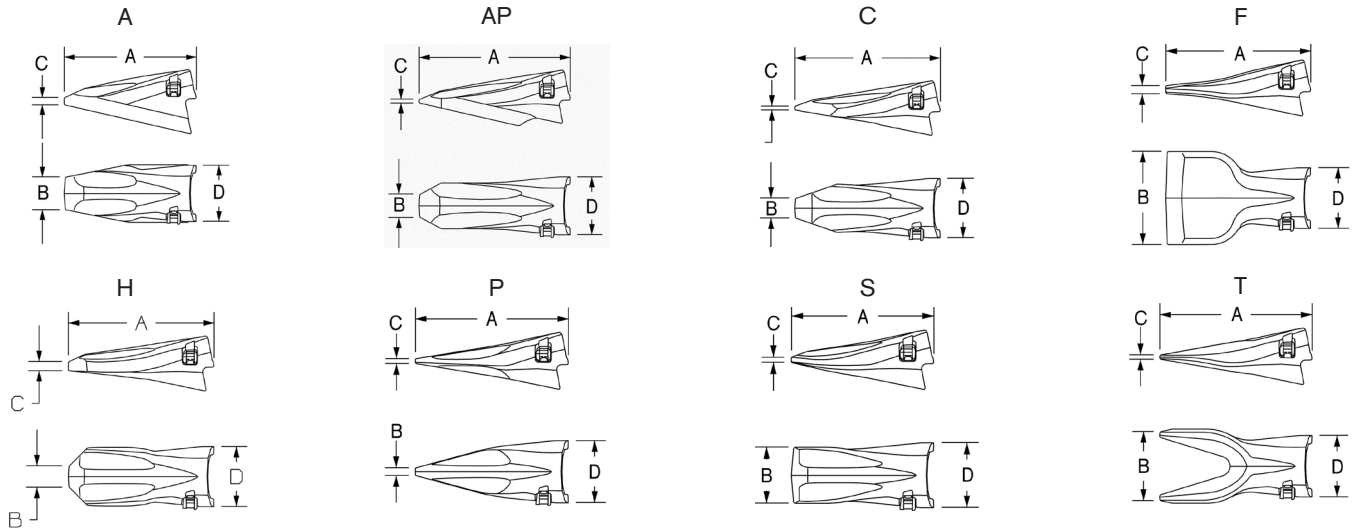

## Ultralok™ Tooth System/Construction U30 Points & Adapters



U30 Points

PART ID	DESCRIPTION	A LENGTH mm/in	B BIT WIDTH mm/in	C BIT THICKNESS mm/in	D OUTSIDE BOX WIDTH mm/in	WEIGHT kg/lb
U30A	Abrasion	251 / 9.88	60 / 2.36	11 / 0.43	105 / 4.15	8.4 / 18.5
U30AP	Abrasion Penetration	275 / 10.85	42 / 1.67	7 / 0.26	105 / 4.15	7.1 / 15.6
U30C	Chisel	259 / 10.20	36 / 1.41	9 / 0.34	105 / 4.15	5.0 / 11.0
U30F	Flare	259 / 10.20	152 / 5.98	14 / 0.53	105 / 4.15	6.5 / 14.3
U30H	Heavy	Future Availability				
U30P	Pick	274 / 10.77	14 / .56	9 / 0.36	105 / 4.15	4.1 / 9.1
U30S	Standard	240 / 9.45	91 / 3.59	10 / 0.39	105 / 4.15	5.0 / 11.0
U30T	Twin Pick	274 / 10.78	125 / 4.91	7 / 0.26	105 / 4.15	5.2 / 11.4

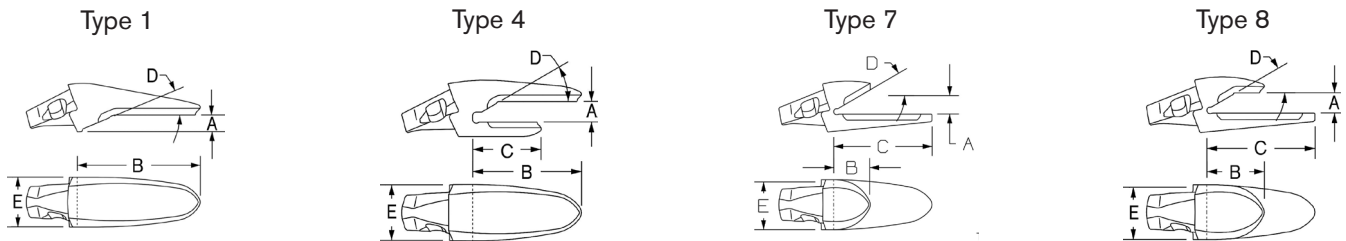

U30 Adapters

PART ID	TYPE	DESCRIPTION	A LIP THICKNESS mm/in	B TOP LEG mm/in	C BOTTOM LEG mm/in	D RAMP ANGLE deg	E ADAPTER WIDTH mm/in	NOSE ANGLE deg	WEIGHT kg/lb	MACHINE TYPE
<b>Excavator</b>										
5849-U30	8	1-1/2 Bottom Leg	30 / 1.25	118 / 4.66	214 / 8.43	30	102 / 4.01	10	9.0 / 19.8	EXC
5850-U30	8	1-1/2 Bottom Leg	40 / 1.50	116 / 4.56	212 / 8.34	30	102 / 4.01	10	8.7 / 19.2	EXC
3871A-U30	7	Bottom Leg	Future Availability							EXC
3881B-U30	8	1-1/2 Bottom Leg	35 / 1.38	116 / 4.56	212 / 8.34	30	102 / 4.01	10	8.8 / 19.4	EXC
<b>Wheel Loader</b>										
802A-U30	4	1-1/2 Top Leg	40 / 1.50	197 / 7.76	97 / 3.82	30	102 / 4.01	15	9.3 / 20.6	FEL
8831-U30	1	Flushmount	40 / 1.50	241 / 9.49	n/a	22.5	102 / 4.01	15	8.9 / 19.7	FEL
8833-U30	4	1-1/2 Top Leg	Future Availability							FEL

**Note:** Weld-on nose will be available in the future.

## Ultralok™ Tooth System/Construction U35 Points & Adapters

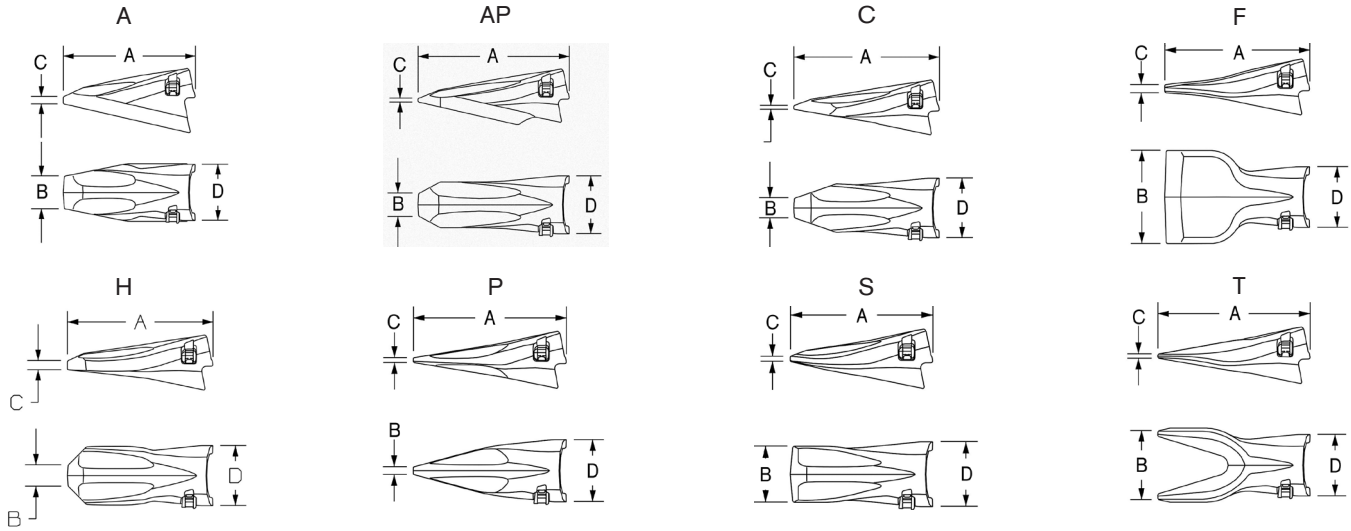

### U35 Points

PART ID	DESCRIPTION	A	B	C	D	WEIGHT kg/lb
		LENGTH mm/in	BIT WIDTH mm/in	BIT THICKNESS mm/in	WIDTH AT EARS mm/in	
U35A	Abrasion	279 / 10.98	69 / 2.72	15 / 0.59	119 / 4.67	12.0 / 26.5
U35AP	Abrasion Penetration	298 / 11.73	48 / 1.89	8 / 0.31	119 / 4.67	10.1 / 22.2
U35C	Chisel	291 / 11.46	40 / 1.58	8 / 0.32	119 / 4.67	7.0 / 15.5
U35F	Flare	287 / 11.28	178 / 7.00	16 / 0.63	119 / 4.67	9.3 / 20.4
U35H	Heavy	Future Availability				
U35P	Pick	298 / 11.71	16 / 0.62	10 / 0.40	119 / 4.67	5.7 / 12.5
U35S	Standard	265 / 10.41	102 / 4.03	11 / 0.43	119 / 4.67	7.0 / 15.3
U35T	Twin Pick	298 / 11.72	143 / 5.62	8 / 0.30	119 / 4.67	7.0 / 15.5

Type 1

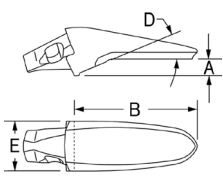

Type 4

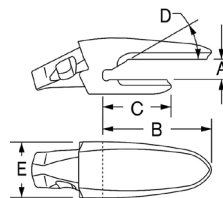

Type 7

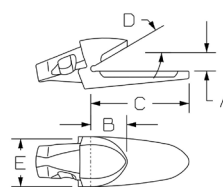

Type 8

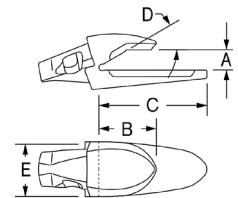

### U35 Adapters

PART ID	TYPE	DESCRIPTION	A	B	C	D	E	NOSE	WEIGHT kg/lb	MACHINE TYPE
			LIP THICKNESS mm/in	TOP LEG mm/in	BOTTOM LEG mm/in	RAMP ANGLE deg	ADAPTER WIDTH mm/in	ANGLE deg		
<b>Excavator</b>										
5855-U35	8	1-1/2 Bottom Leg	40 / 1.50	127 / 5.00	235 / 9.25	30	115 / 4.53	10	11.9 / 26.3	EXC
3872A-U35	7	Bottom Leg	Future Availability							EXC
3810B-U35	8	1-1/2 Bottom Leg	45 / 1.75	127 / 5.00	235 / 9.25	30	115 / 4.53	10	12.2 / 27.0	EXC
<b>Wheel Loader</b>										
8833-U35	4	1-1/2 Top Leg	40 / 1.50	217 / 8.52	108 / 4.27	22.5-25	115 / 4.53	15	12.6 / 27.8	FEL
8831-U35	1	Flushmount	40 / 1.50	252 / 9.94	n/a	22.5-25	115 / 4.53	15	12.2 / 26.9	FEL

**Note:** Weld-on nose will be available in the future.

## Ultralok™ Tooth System/Construction U45 Points & Adapters

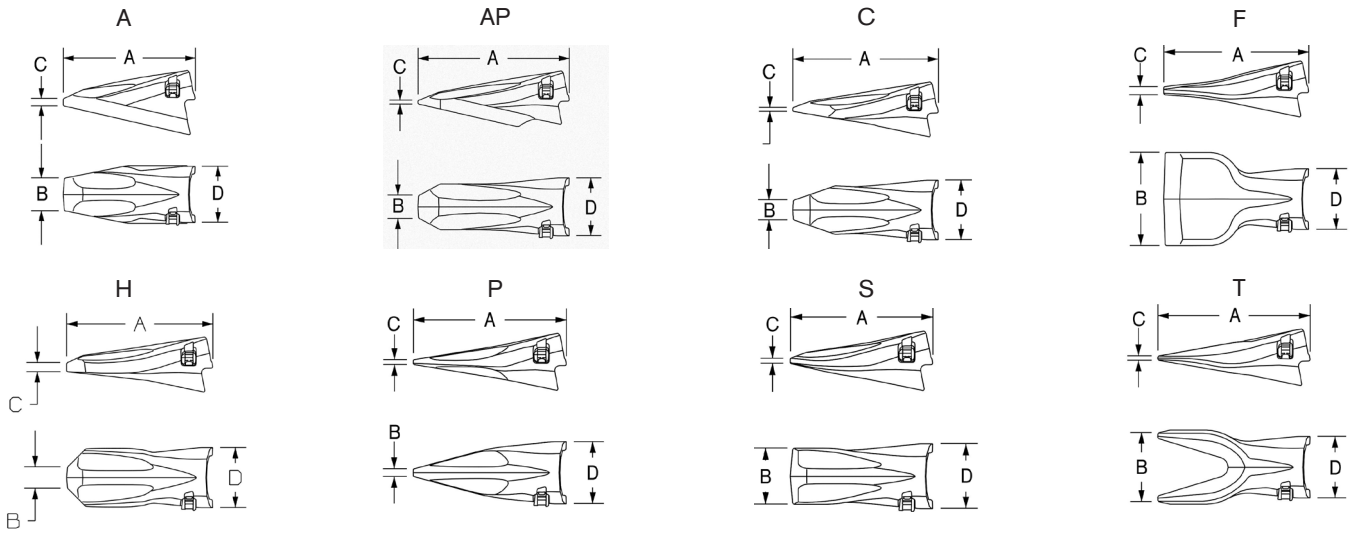

### U45 Points

PART ID	DESCRIPTION	A	B	C	D	WEIGHT kg/lb
		LENGTH mm/in	BIT WIDTH mm/in	BIT THICKNESS mm/in	OUTSIDE BOX WIDTH mm/in	
U45A	Abrasion	351 / 13.81	87 / 3.42	19 / 0.76	149 / 5.87	24 / 53
U45AP	Abrasion Penetration	390 / 15.36	58 / 2.26	10 / 0.39	149 / 5.87	20 / 44
U45C	Chisel	366 / 14.41	50 / 1.98	10 / 0.39	149 / 5.87	14 / 31
U45F	Flare	356 / 14.03	228 / 8.99	20 / 0.79	149 / 5.87	18 / 41
U45H	Heavy	Future Availability				
U45P	Pick	369 / 14.53	19 / 0.73	12 / 0.46	149 / 5.87	11 / 25
U45S	Standard	328 / 12.93	129 / 5.07	13 / 0.52	149 / 5.87	14 / 30
U45T	Twin Pick	370 / 14.55	180 / 7.09	11 / 0.42	149 / 5.87	14 / 30

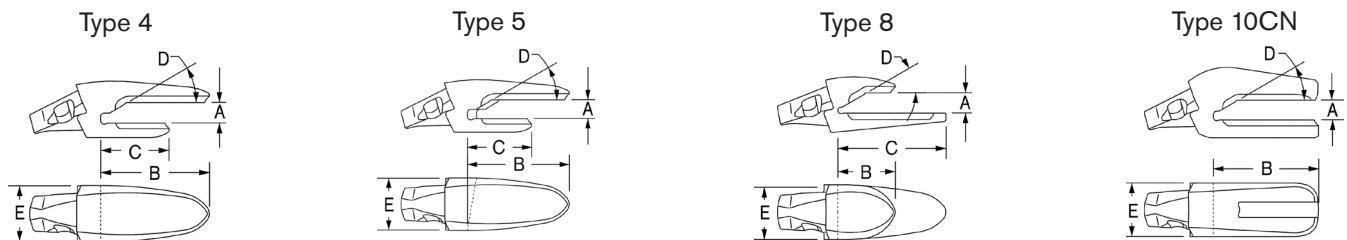

### U45 Adapters

PART ID	TYPE	DESCRIPTION	A	B	C	D	E	NOSE	WEIGHT kg/lb	MACHINE TYPE
			LIP THICKNESS mm/in	TOP LEG mm/in	BOTTOM LEG mm/in	RAMP ANGLE deg	ADAPTER WIDTH mm/in	ANGLE deg		
<b>Excavator</b>										
5856-U45	8	1-1/2 Bottom Leg	50 / 2.00	151 / 5.96	285 / 11.22	30	144 / 5.67	10	23 / 50	EXC
3811-U45	8	1-1/2 Bottom Leg	Future Availability							EXC
3810A-U45	8	1-1/2 Bottom Leg	Future Availability							EXC
<b>Wheel Loader</b>										
1812L-U45	5	1-1/2 Top Leg Spade	50 / 2.00	283 / 11.15	179 / 7.03	30	144 / 5.67	15	28 / 62	Loadmaster
1812R-U45	5	1-1/2 Top Leg Spade	50 / 2.00	283 / 11.15	179 / 7.03	30	144 / 5.67	15	28 / 62	Loadmaster
1837A-U45	4	1-1/2 Top Leg	50 / 2.00	283 / 11.15	179 / 7.03	30	144 / 5.67	15	27 / 60	Loadmaster
8854-U45	10CN	Straddle Leg	50 / 2.00	283 / 11.15	285 / 11.22	30	144 / 5.67	15	41 / 90	Loadmaster
1810-U45	4	1-1/2 Top Leg	Future Availability							FEL
1810R-U45	5	1-1/2 Top Leg Spade	Future Availability							FEL
1810L-U45	5	1-1/2 Top Leg Spade	Future Availability							FEL
1836-U45	1	Flushmount	Future Availability							FEL
414B-U45	28	2 Leg Center	Future Availability							Zipper Lip
415B-U45	29	2 Leg Corner	Future Availability							Zipper Lip

**Note:** Weld-on nose will be available in the future.